

**AMENDMENT NUMBER TWO
TO PROFESSIONAL SERVICES AGREEMENT
WITH
GILLIS & PANICHAPAN ARCHITECTS, INCORPORATED**

THIS AMENDMENT NUMBER TWO ("Amendment") is made and entered into this 1st day of February, 2022 ("Effective Date"), by and between the CITY OF COSTA MESA, a municipal corporation ("City"), and GILLIS & PANICHAPAN ARCHITECTS, INCORPORATED, a California corporation ("Consultant").

WHEREAS, City and Consultant entered into an agreement dated January 21, 2020 for Consultant to provide professional design services and construction support services in connection with the Costa Mesa Police Department Shooting Range Upgrade Project, now referred to as the Police Department Range Remodel and Upgrades Project (the "Agreement"); and

WHEREAS, Section 4.1 of the Agreement provides for a term of two (2) years, with the option to extend the term for one (1) additional one (1) year period; and

WHEREAS, City and Consultant extended the term through January 20, 2023, through Amendment Number One to the Agreement, dated January 20, 2022; and

WHEREAS, City and Consultant now desire to amend the Scope of Services to include the additional services identified as Tasks 1 and 2 in Exhibit "A," attached hereto and incorporated herein; and

WHEREAS, City desires to increase Consultant's maximum compensation accordingly to One Hundred Thirty-Eight Thousand Two Hundred Forty-Three Dollars (\$138,243.00).

NOW, THEREFORE, for valuable consideration, the receipt and sufficiency of which is hereby acknowledged, the parties agree as follows:

1. The Scope of Services shall be amended to include the additional services identified as Tasks 1 and 2 in Exhibit A.
2. Section 2.1 of the Agreement shall be amended to reflect that Consultant's total compensation shall not exceed One Hundred Thirty-Eight Thousand Two Hundred Forty-Three Dollars (\$138,243.00).
3. All terms not defined herein shall have the same meaning and use as set forth in the Agreement.
4. All other terms, conditions, and provisions of the Agreement not in conflict with this Amendment shall remain in full force and effect.
5. This Amendment may be executed in one or more counterparts, each of which shall be deemed an original. All counterparts shall be construed together and shall constitute one agreement.

IN WITNESS WHEREOF, the parties hereto have caused this Amendment to be executed by and through their respective authorized officers, as of the date first written above.

CITY OF COSTA MESA

Lori Ann Jones H
City Manager

Date: 3/01/2022

CONSULTANT

Longkavach Panichapan
Longkavach Panichapan
President/CEO

Date: 2/10/2022

ATTEST:

Brenda Green 3/2/2022
City Clerk



APPROVED AS TO FORM:

Kimberly Lee Berlow
City Attorney

Date: 3/1/22

APPROVED AS TO INSURANCE:

[Signature]
Risk Management

Date: 2/15/22

APPROVED AS TO CONTENT:

S. Yang
Project Manager

Date: 2/15/2022

DEPARTMENTAL APPROVAL:



Public Services Director

Date: 2-15-22

APPROVED AS TO PURCHASING:



Finance Director

Date: 2/23/22

EXHIBIT A
ADDITIONAL SERVICES

October 19, 2021

Seung Yang, P.E.
City Engineer
City of Costa Mesa
77 Fair Dr. Costa Mesa CA 92626

Subject: **City of Costa Mesa Police Firing Range: Change Order Requests for ADA and Construction Administration Support Services**

Dear Seung,

We are seeking a change order request for additional work we had provided for this project, as well as additional work we anticipate to provide due to the expanded scope of work to cover ADA retrofits and accessibility improvements for the facility to accommodate the original scope of the Firing Range at the Police Station.

A. SCOPE OF WORK SUMMARY

The requested change orders for this project are based on the following three (3) tasks that provide additions and alterations to the original scope of work:

1. **ADA Assessment Report:** (Originally submitted 3/4/21) Provide Accessibility/ ADA Assessment Report on the the facility based as it relates to the primary proposed renovation for the Firing Range. Report illustrating existing conditions that would need upgrades and retrofits (Exhibit A)
2. **A&E services for ADA retrofits:** (Originally submitted 5/26/21) Provide A&E services to develop construction documents through construction support for selected ADA retrofits outlined in the Accessibility/ ADA report. (Exhibit B)
3. **Supplemental Construction Administration*:** (New) Construction Support Services for the expanded scope of work. (Exhibit C) *

*Regarding third task #3, we are requesting this change order for additional Construction Administration services work due partially to the expanded scope of work provided over the course of the project up to this time.

During the course of the project, there were not enough funds to cover the accessibility coordination within the existing scope. These additional services provided needed to be allocated from funds originally dedicated to future phases of the project (Including the original Construction Administration Phase) to develop solutions and conceptual schemes to address the Accessibility constraints and obstructions of the existing facility above and beyond original scope of the Firing Range. It included coordination with City Building Department and Plan check to determine the final scope and extent of the ADA retrofits.

B. COMPENSATION

The following are the proposed fees for each respective tasks followed by a grand total not to exceed:

1. **ADA Assessment Report**
\$2,933 (Two Thousand Nine Hundred and Thirty-Three Dollars)

2. **A&E services for ADA retrofits:**
\$35,480 (Thirty-Five Thousand Four Hundred and Eighty Dollars)

3. **Supplemental Construction Administration:**
\$32,000 (Thirty-two Thousand Dollars)

GRAND TOTAL FOR ALL 3 TASKS: \$70,413
(Seventy Thousand, Four Hundred and thirteen dollars)

Refer to attached Exhibits A, B, and C for additional details about each respective task.

Additional services outside the Scope of Work agreed upon shall not be performed without the authorization of the City. We have tailored our scope and subsequent fee proposal to accommodate the scope of work, realizing that there is latitude in both parameters to be discussed during the contract negotiation.

Sincerely,



Jack Panichapan, AIA, LEED AP, President, CEO
Gillis + Panichapan Architects, Inc.

**EXHIBIT A:
ADA ASSESSMENT REPORT**



March 4, 2021

Seung Yang, P.E.
 City Engineer
 City of Costa Mesa
 77 Fair Dr. Costa Mesa CA 92626

Subject: **City of Costa Mesa Police Firing Range: ADA Report and Assessments**

Dear Seung,

The following work outlined is in response to potential ADA accessible code requirements by the City of Costa Mesa triggered by the proposed renovations for the new Firing Range located at the City's Police Headquarters at 99 Fair Drive. Based on building code requirements, the proposed renovation would require additional building and site improvements/ verification to meet current code requirements for accessibility per section 11B-202.1 of the CBC.

We will be coordinating with the Accessibility consultant to determine the potential of retrofits required by code, and help the City determine an accessibility retrofit scope for this project to fulfill Plan Check requirements for ADA accessibility.

A. SCOPE OF WORK SUMMARY

- Provide Report illustrating existing conditions that would need accessible code upgrades (see attached consultant proposal).

B. CONSULTANTS

We will plan to utilize the following consultants:

Accessibility Consultant
 Casper Development Resources, Inc
 5360 Jackson Drive, Suite 114 La Mesa, Ca 91942
 619.741.1080

(Please refer to attached consultant proposal)

C. COMPENSATION

We propose to furnish these services not to exceed:

\$2,550 (Two Thousand Five Hundred and Fifty Dollars) includes potential consultant reimbursable and expenses
 + 15% administrative coordination (\$383)

\$2,933 (Two Thousand Nine Hundred and Thirty-Three Dollars)

Please see attached consultant proposal. Additional services outside the Scope of Work agreed upon shall not be performed without the authorization of the City. We have tailored our scope and subsequent fee proposal to accommodate the scope of work, realizing that there is latitude in both parameters to be discussed during the contract negotiation.

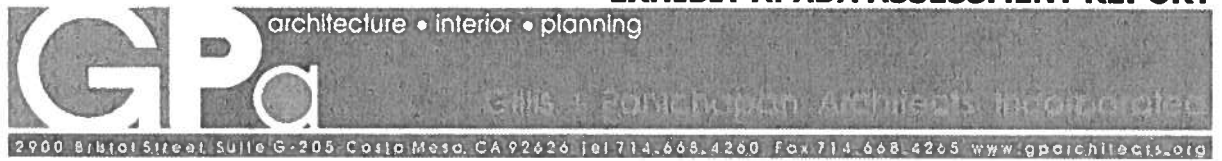

Sincerely,

Jack Panichapan, AIA, LEED AP, President, CEO
Gillis + Panichapan Architects, Inc.

EXHIBIT A - DESCRIPTION OF SERVICES

A. SERVICES

A.1 SITE EVALUATION SURVEY

Consultant shall conduct a Facility Inspection (“Inspection”) of the facility(s) listed in Exhibit “A-1” (the “Facility”). The portion of each facility included in the Inspection is limited to those areas identified in “Exhibit A-1” and as further limited by the following.

The Inspection shall, unless otherwise excepted herein, compare elements with: (i) the current new building construction requirements of the Americans with Disabilities Act Accessibility Standards (the “ADAS”) and (ii) the current new building provisions of the California Building Code that exclusively and unambiguously address disabled access issues (the “CBC”).

Consultant shall only examine those features that are: (1) required to be evaluated hereunder and (2) specifically and unambiguously required to be accessible pursuant to the ADAS and CBC as Consultant understands these obligations.

Consultant shall not be responsible for any analysis in connection with fire alarms or any other alarm system or the operating condition of any telephones, assistive listening system or any other electronic device of any nature whatsoever. Consultant shall not be responsible for examining any feature or facility outside the boundary of a Facility, including without limitation, any feature in any public right-of-way. Consultant shall not be responsible to analyze any policy or procedures.

Though Consultant shall use its reasonable best efforts to locate and evaluate features required to be accessible under the ADAS and CBC, Consultant and Client agree that an occasional and/or immaterial failure to identify and/or evaluate any particular subject feature will not be deemed to be a breach of Consultant’s duties hereunder.

A.2 REPORT - (NON-CRASCA)

Consultant shall memorialize the findings of the SES in a written standardized report (“Report”).

The report is not intended to conform to the requirements of the Construction-Related Accessibility Standards Compliance Act (CRASCA, CA Civil Code 55.51–55.545).

The Report shall identify elements which do not conform to the new construction related ADAS or CBC requirement. Consultant shall include a color digital photograph of each element identified as non-conforming.

In the event that any specific area, feature or item (or portion thereof) does not reflect the relevant requirements of ADAS or CBC/DA, Consultant shall attempt to make a simple and general “recommendation.” Each recommendation comes from a standard list or possible recommendations for features similar to the feature being evaluated. The recommendation is derived from a basic cursory examination of each subject feature and

EXHIBIT A: ADA ASSESSMENT REPORT

represents only one possible physical solution to bring the subject feature into comparative compliance with ADAS and CBC/DA New Construction standards.

Consultant shall deliver one electronic copy of each Report to Client in Adobe PDF format.

B. EXCLUSIONS

Consultant shall not be obligated to provide any services other than those set forth in Section A.1 and A.2, above, including, without limitation, the following:

- a. Services related to the portions of the ADA dealing with employment policies, transportation issues and telecommunications.
- b. Analysis of the requirement of Section 504 of the Rehabilitation Act of 1973.
- c. Analysis of concealed or unknown conditions or characteristics of any facility or performance of destructive testing of any sort or nature.
- d. Analysis of survey of any facility's compliance with applicable codes and standards (excluding Disabled Access Laws) including, but not limited to building, health, zoning, seismic and life safety codes.
- e. Design or construction work of any nature whatsoever.
- f. Any research or analysis of the permit history or construction dates of any building or facility.

C. CLIENT DUTIES REGARDING SITE EVALUATION

Client shall provide the following:

- a) Client shall provide Consultant with the right to enter from time to time, property owned by the Client and/or others so Consultant may perform the Services.

D. SCHEDULE

Consultant shall perform the services outlined in A.1 & A.2 (Inspection and Report) within thirty (30) days of receiving a fully executed contract.

Consultant shall perform the services outlined in A.3 (Review of Phasing Schedule) within fourteen (14) days of receiving the schedule from Client.

E. MISCELLANEOUS

All services shall be performed by a minimum of one of the following persons:

Neal Casper
CASp-020
Expiration 9/29/2020

EXHIBIT A: ADA ASSESSMENT REPORT

EXHIBIT "B" - FEE FOR SERVICES

Consultant and Client agree that Consultant shall charge a fee (the "Fee") of **\$2,400.00** or the provision of Services set forth in Sections A.1, A.2 and A.3 of Exhibit "A".

Travel Expenses (estimated at \$105.00)

If Consultant utilizes their automobiles in the provision of services, mileage shall be charged at the published IRS mileage rate (currently \$0.56 per mile).

Miscellaneous

Client understands and affirms that this Agreement is between Client and Consultant only and payment to Consultant by Client is not dependent upon Client's reimbursement of Consultant's fees, costs and expenses by any third parties whatsoever.

Unless otherwise agreed in writing, all fees and costs shall be due and payable within thirty (30) days of the date upon which they are invoiced to Client. Any sums not paid when due and payable shall accrue interest at a rate of 15% per annum until paid in full.

ADDITIONAL SERVICES

Additional services, should they be requested, including consulting time connected with Consultant's finding, shall be billed in accordance with Exhibit C - Standard Rates.

EXHIBIT A: ADA ASSESSMENT REPORT

EXHIBIT "C" - STANDARD RATES

Principal Consultant/Expert Rates

Document or Plan Review (2hr minimum):	\$250 per hour
Research, Investigation or Consulting (4hr minimum):	\$250 per hour
Deposition or Sworn Testimony:	\$375 per hour

Associate or Administrative Rates

Document or Plan Review (Associate):	\$150 per hour
Research, Investigation or Consulting (Associate):	\$150 per hour
Technical / Clerical or Administrative:	\$100 per hour

Consultant's hourly rates shall be billed in ¼ hour increments.

Travel Time

Consultant shall be entitled to compensation for Travel Time while away from his office. Travel Time will be charged to Client at Consultant's regular hourly rate from the time of departure from Consultant's office until the time of return (portal to portal).

Expenses – Travel-Related & Other

Client shall reimburse Consultant for all reasonable costs (including, without limitation, photocopying, parking, travel expenses, overnight delivery charges, messenger service and printing) in an amount equal to said costs plus a markup of 10%.

Travel Expenses include, but are not limited to:

1. Parking Garages, tolls & airport
2. Airfare Flights 0-2 hours - Refundable Coach
 Flights 2-4 hours – Refundable Coach Plus & Wifi
 Flights 4+ hours – First Class & Wifi
 (Time based on total duration for day's flight(s))
3. Hotel Business class
4. Meals Breakfast / Lunch / Dinner
5. Car Rental Intermediate class

Expenses – Use of Personal Vehicles

In the event that Consultant or staff utilizes their automobiles in connection with the provision of Services, mileage shall be charged at the standard mileage rate published by the IRS from time to time (currently \$0.56 per mile).

Terms

Unless otherwise agreed in writing, all fees and costs shall be due and payable within thirty (30) days of the date upon which they are invoiced to Client. Any sums not paid when due and payable shall accrue interest at a rate of 15% per annum until paid in full.

Client understands and affirms that this Agreement is between Client and Consultant only and payment to Consultant by Client is not dependent upon Client's reimbursement of Consultant's fees, costs and expenses by any third parties whatsoever.

EXHIBIT A-1 – FACILITIES

Costa Mesa Police Facility
99 Fair Drive
Costa Mesa, CA

Inspection limited to the path of travel serving the basement shooting range as marked on the attached plans (dotted red line) including:

1. Accessible parking near the building entrance
2. Accessible route between city sidewalk, accessible parking and the facility entrance
3. Route from facility entrance to the basement (elevator / stairs / hallways)
4. Basement toilet and shower rooms

EXHIBIT A: ADA ASSESSMENT REPORT

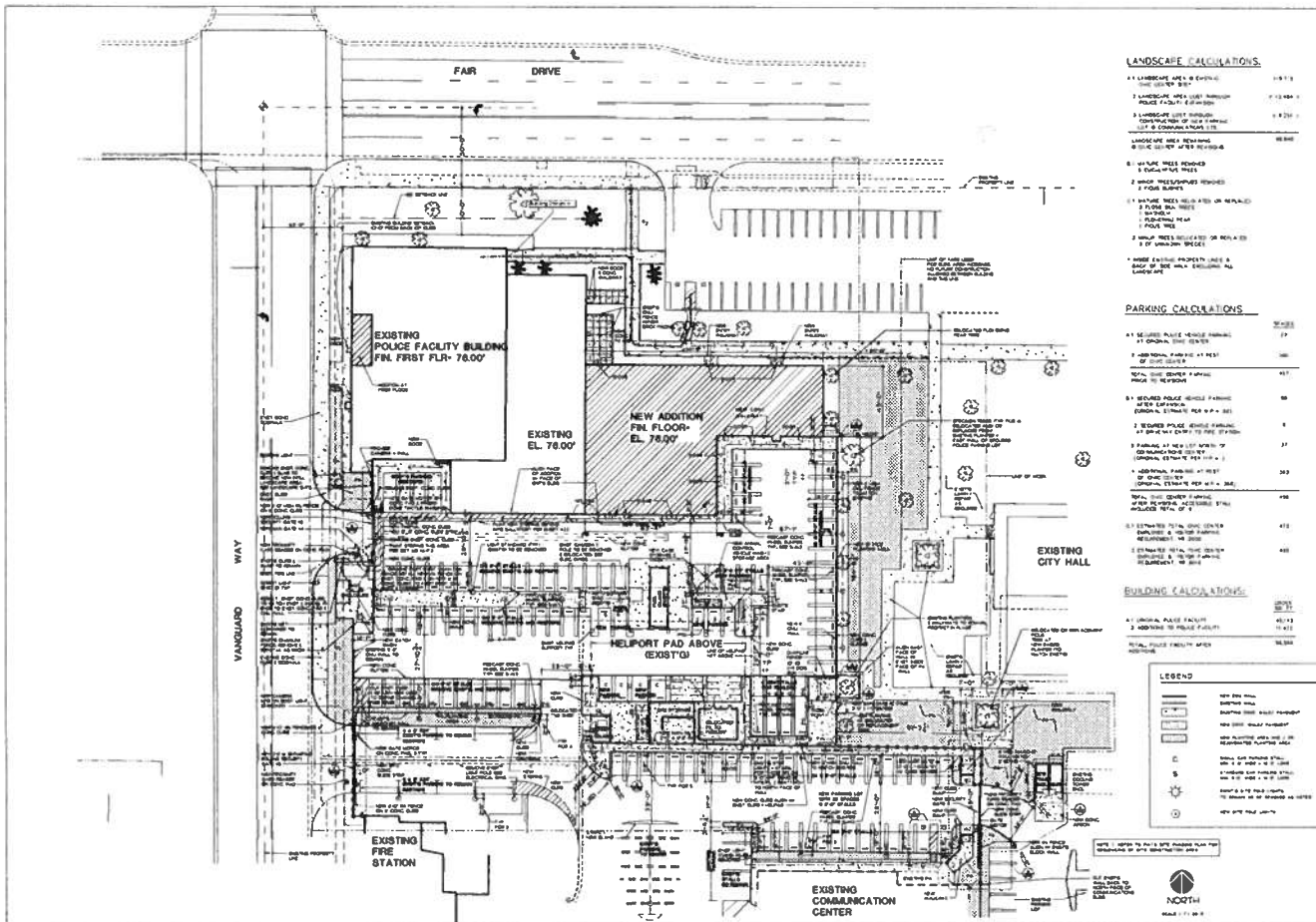

LANDSCAPE CALCULATIONS

1 LANDSCAPE AREA & COVER	197.3
2 LANDSCAPE AREA UNDER IMPROVEMENT	173.484
3 LANDSCAPE AREA TO BE MAINTAINED	173.484
4 LANDSCAPE AREA TO BE MAINTAINED	173.484
5 LANDSCAPE AREA TO BE MAINTAINED	173.484
6 LANDSCAPE AREA TO BE MAINTAINED	173.484
7 LANDSCAPE AREA TO BE MAINTAINED	173.484
8 LANDSCAPE AREA TO BE MAINTAINED	173.484
9 LANDSCAPE AREA TO BE MAINTAINED	173.484
10 LANDSCAPE AREA TO BE MAINTAINED	173.484
11 LANDSCAPE AREA TO BE MAINTAINED	173.484
12 LANDSCAPE AREA TO BE MAINTAINED	173.484
13 LANDSCAPE AREA TO BE MAINTAINED	173.484
14 LANDSCAPE AREA TO BE MAINTAINED	173.484
15 LANDSCAPE AREA TO BE MAINTAINED	173.484
16 LANDSCAPE AREA TO BE MAINTAINED	173.484
17 LANDSCAPE AREA TO BE MAINTAINED	173.484
18 LANDSCAPE AREA TO BE MAINTAINED	173.484
19 LANDSCAPE AREA TO BE MAINTAINED	173.484
20 LANDSCAPE AREA TO BE MAINTAINED	173.484
21 LANDSCAPE AREA TO BE MAINTAINED	173.484
22 LANDSCAPE AREA TO BE MAINTAINED	173.484
23 LANDSCAPE AREA TO BE MAINTAINED	173.484
24 LANDSCAPE AREA TO BE MAINTAINED	173.484
25 LANDSCAPE AREA TO BE MAINTAINED	173.484
26 LANDSCAPE AREA TO BE MAINTAINED	173.484
27 LANDSCAPE AREA TO BE MAINTAINED	173.484
28 LANDSCAPE AREA TO BE MAINTAINED	173.484
29 LANDSCAPE AREA TO BE MAINTAINED	173.484
30 LANDSCAPE AREA TO BE MAINTAINED	173.484
31 LANDSCAPE AREA TO BE MAINTAINED	173.484
32 LANDSCAPE AREA TO BE MAINTAINED	173.484
33 LANDSCAPE AREA TO BE MAINTAINED	173.484
34 LANDSCAPE AREA TO BE MAINTAINED	173.484
35 LANDSCAPE AREA TO BE MAINTAINED	173.484
36 LANDSCAPE AREA TO BE MAINTAINED	173.484
37 LANDSCAPE AREA TO BE MAINTAINED	173.484
38 LANDSCAPE AREA TO BE MAINTAINED	173.484
39 LANDSCAPE AREA TO BE MAINTAINED	173.484
40 LANDSCAPE AREA TO BE MAINTAINED	173.484
41 LANDSCAPE AREA TO BE MAINTAINED	173.484
42 LANDSCAPE AREA TO BE MAINTAINED	173.484
43 LANDSCAPE AREA TO BE MAINTAINED	173.484
44 LANDSCAPE AREA TO BE MAINTAINED	173.484
45 LANDSCAPE AREA TO BE MAINTAINED	173.484
46 LANDSCAPE AREA TO BE MAINTAINED	173.484
47 LANDSCAPE AREA TO BE MAINTAINED	173.484
48 LANDSCAPE AREA TO BE MAINTAINED	173.484
49 LANDSCAPE AREA TO BE MAINTAINED	173.484
50 LANDSCAPE AREA TO BE MAINTAINED	173.484

PARKING CALCULATIONS

1 REQUIRED PARKING SPACES	173
2 REQUIRED PARKING SPACES	173
3 REQUIRED PARKING SPACES	173
4 REQUIRED PARKING SPACES	173
5 REQUIRED PARKING SPACES	173
6 REQUIRED PARKING SPACES	173
7 REQUIRED PARKING SPACES	173
8 REQUIRED PARKING SPACES	173
9 REQUIRED PARKING SPACES	173
10 REQUIRED PARKING SPACES	173
11 REQUIRED PARKING SPACES	173
12 REQUIRED PARKING SPACES	173
13 REQUIRED PARKING SPACES	173
14 REQUIRED PARKING SPACES	173
15 REQUIRED PARKING SPACES	173
16 REQUIRED PARKING SPACES	173
17 REQUIRED PARKING SPACES	173
18 REQUIRED PARKING SPACES	173
19 REQUIRED PARKING SPACES	173
20 REQUIRED PARKING SPACES	173
21 REQUIRED PARKING SPACES	173
22 REQUIRED PARKING SPACES	173
23 REQUIRED PARKING SPACES	173
24 REQUIRED PARKING SPACES	173
25 REQUIRED PARKING SPACES	173
26 REQUIRED PARKING SPACES	173
27 REQUIRED PARKING SPACES	173
28 REQUIRED PARKING SPACES	173
29 REQUIRED PARKING SPACES	173
30 REQUIRED PARKING SPACES	173
31 REQUIRED PARKING SPACES	173
32 REQUIRED PARKING SPACES	173
33 REQUIRED PARKING SPACES	173
34 REQUIRED PARKING SPACES	173
35 REQUIRED PARKING SPACES	173
36 REQUIRED PARKING SPACES	173
37 REQUIRED PARKING SPACES	173
38 REQUIRED PARKING SPACES	173
39 REQUIRED PARKING SPACES	173
40 REQUIRED PARKING SPACES	173
41 REQUIRED PARKING SPACES	173
42 REQUIRED PARKING SPACES	173
43 REQUIRED PARKING SPACES	173
44 REQUIRED PARKING SPACES	173
45 REQUIRED PARKING SPACES	173
46 REQUIRED PARKING SPACES	173
47 REQUIRED PARKING SPACES	173
48 REQUIRED PARKING SPACES	173
49 REQUIRED PARKING SPACES	173
50 REQUIRED PARKING SPACES	173

BUILDING CALCULATIONS

1 ORIGINAL POLICE FACILITY	173
2 ADDITION TO POLICE FACILITY	173
3 TOTAL POLICE FACILITY AREA	173

LEGEND

1	EXISTING BUILDING
2	NEW ADDITION
3	EXISTING DRIVE
4	NEW DRIVE
5	EXISTING SIDEWALK
6	NEW SIDEWALK
7	EXISTING RAMP
8	NEW RAMP
9	EXISTING SIGNAGE
10	NEW SIGNAGE
11	EXISTING LIGHTING
12	NEW LIGHTING
13	EXISTING FENCE
14	NEW FENCE
15	EXISTING LANDSCAPE
16	NEW LANDSCAPE
17	EXISTING UTILITY
18	NEW UTILITY
19	EXISTING EROSION CONTROL
20	NEW EROSION CONTROL
21	EXISTING WATER
22	NEW WATER
23	EXISTING SEWER
24	NEW SEWER
25	EXISTING STORMWATER
26	NEW STORMWATER
27	EXISTING AIR
28	NEW AIR
29	EXISTING GROUND
30	NEW GROUND
31	EXISTING VEGETATION
32	NEW VEGETATION
33	EXISTING UTILITIES
34	NEW UTILITIES
35	EXISTING EROSION CONTROL
36	NEW EROSION CONTROL
37	EXISTING WATER
38	NEW WATER
39	EXISTING SEWER
40	NEW SEWER
41	EXISTING STORMWATER
42	NEW STORMWATER
43	EXISTING AIR
44	NEW AIR
45	EXISTING GROUND
46	NEW GROUND
47	EXISTING VEGETATION
48	NEW VEGETATION
49	EXISTING UTILITIES
50	NEW UTILITIES

MEYER & ALLEN ASSOCIATES
ARCHITECTS

1000 AVENUE OF THE STARS
SUITE 1000
COSTA MESA, CALIFORNIA 92626
TEL: 714.440.1000
WWW.MEYERANDALLEN.COM

APPROVED BY: _____

COSTA MESA POLICE FACILITY Expansion & Renovation
City of Costa Mesa
99 Fair Drive
Costa Mesa, CA 92626

DESIGNED BY: _____ 310.03
CHECKED BY: _____
DATE: _____

SITE PLAN

SHEET
A1.1
OF SHEETS

EXHIBIT A: ADA ASSESSMENT REPORT

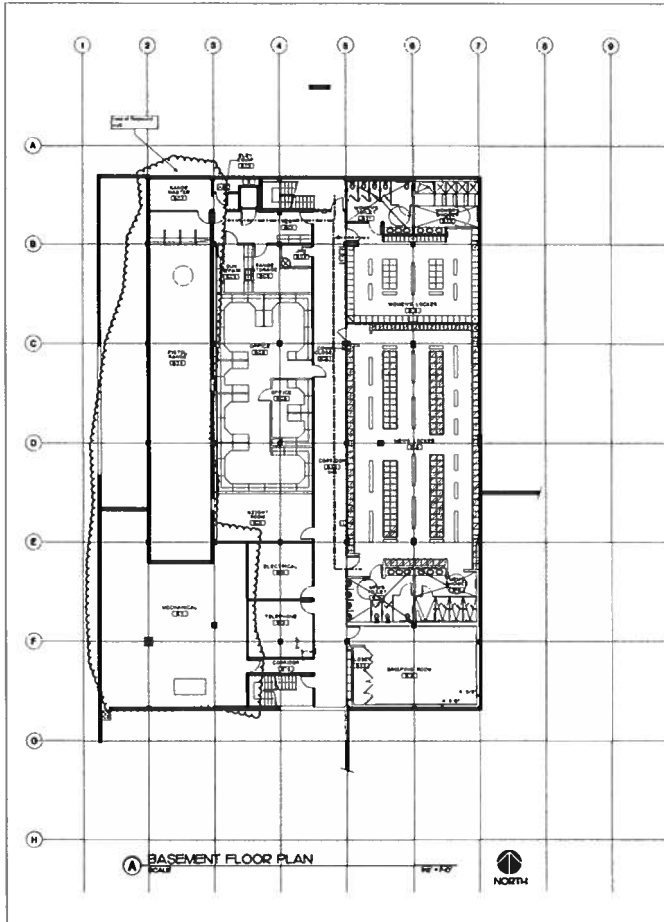

GENERAL NOTES	SCHEDULE LEGEND	WALL TYPES LEGEND
<p>1. SEE ALL NOTES ON SHEET 01-100 FOR GENERAL NOTES AND SPECIFICATIONS TO BE FOLLOWED.</p> <p>2. ALL WORK SHALL BE IN ACCORDANCE WITH THE 2012 CALIFORNIA BUILDING CODE AND ALL APPLICABLE LOCAL ORDINANCES.</p> <p>3. PROVIDE SLOPED WALKWAYS TO ALL EXISTING AND PROPOSED CURBS TO MEET THE 1:12 SLOPE REQUIREMENT.</p> <p>4. PROVIDE SLOPED WALKWAYS TO ALL EXISTING AND PROPOSED CURBS TO MEET THE 1:12 SLOPE REQUIREMENT.</p> <p>5. PROVIDE SLOPED WALKWAYS TO ALL EXISTING AND PROPOSED CURBS TO MEET THE 1:12 SLOPE REQUIREMENT.</p> <p>6. PROVIDE SLOPED WALKWAYS TO ALL EXISTING AND PROPOSED CURBS TO MEET THE 1:12 SLOPE REQUIREMENT.</p> <p>7. PROVIDE SLOPED WALKWAYS TO ALL EXISTING AND PROPOSED CURBS TO MEET THE 1:12 SLOPE REQUIREMENT.</p> <p>8. PROVIDE SLOPED WALKWAYS TO ALL EXISTING AND PROPOSED CURBS TO MEET THE 1:12 SLOPE REQUIREMENT.</p> <p>9. PROVIDE SLOPED WALKWAYS TO ALL EXISTING AND PROPOSED CURBS TO MEET THE 1:12 SLOPE REQUIREMENT.</p>	<p>1. 1/2\"/> </p>	<p>1. 1/2\"/> </p>

FINISH ACCESSORIES KEYNOTES	FINISH ACCESSORIES	FINISH ACCESSORIES
1. 1/2\"/>	1. 1/2\"/>	1. 1/2\"/>
2. 1/2\"/>	2. 1/2\"/>	2. 1/2\"/>
3. 1/2\"/>	3. 1/2\"/>	3. 1/2\"/>
4. 1/2\"/>	4. 1/2\"/>	4. 1/2\"/>
5. 1/2\"/>	5. 1/2\"/>	5. 1/2\"/>
6. 1/2\"/>	6. 1/2\"/>	6. 1/2\"/>
7. 1/2\"/>	7. 1/2\"/>	7. 1/2\"/>
8. 1/2\"/>	8. 1/2\"/>	8. 1/2\"/>
9. 1/2\"/>	9. 1/2\"/>	9. 1/2\"/>
10. 1/2\"/>	10. 1/2\"/>	10. 1/2\"/>
11. 1/2\"/>	11. 1/2\"/>	11. 1/2\"/>
12. 1/2\"/>	12. 1/2\"/>	12. 1/2\"/>
13. 1/2\"/>	13. 1/2\"/>	13. 1/2\"/>
14. 1/2\"/>	14. 1/2\"/>	14. 1/2\"/>
15. 1/2\"/>	15. 1/2\"/>	15. 1/2\"/>
16. 1/2\"/>	16. 1/2\"/>	16. 1/2\"/>
17. 1/2\"/>	17. 1/2\"/>	17. 1/2\"/>
18. 1/2\"/>	18. 1/2\"/>	18. 1/2\"/>
19. 1/2\"/>	19. 1/2\"/>	19. 1/2\"/>
20. 1/2\"/>	20. 1/2\"/>	20. 1/2\"/>
21. 1/2\"/>	21. 1/2\"/>	21. 1/2\"/>
22. 1/2\"/>	22. 1/2\"/>	22. 1/2\"/>
23. 1/2\"/>	23. 1/2\"/>	23. 1/2\"/>
24. 1/2\"/>	24. 1/2\"/>	24. 1/2\"/>
25. 1/2\"/>	25. 1/2\"/>	25. 1/2\"/>
26. 1/2\"/>	26. 1/2\"/>	26. 1/2\"/>
27. 1/2\"/>	27. 1/2\"/>	27. 1/2\"/>
28. 1/2\"/>	28. 1/2\"/>	28. 1/2\"/>
29. 1/2\"/>	29. 1/2\"/>	29. 1/2\"/>
30. 1/2\"/>	30. 1/2\"/>	30. 1/2\"/>
31. 1/2\"/>	31. 1/2\"/>	31. 1/2\"/>
32. 1/2\"/>	32. 1/2\"/>	32. 1/2\"/>
33. 1/2\"/>	33. 1/2\"/>	33. 1/2\"/>
34. 1/2\"/>	34. 1/2\"/>	34. 1/2\"/>
35. 1/2\"/>	35. 1/2\"/>	35. 1/2\"/>
36. 1/2\"/>	36. 1/2\"/>	36. 1/2\"/>
37. 1/2\"/>	37. 1/2\"/>	37. 1/2\"/>
38. 1/2\"/>	38. 1/2\"/>	38. 1/2\"/>
39. 1/2\"/>	39. 1/2\"/>	39. 1/2\"/>
40. 1/2\"/>	40. 1/2\"/>	40. 1/2\"/>
41. 1/2\"/>	41. 1/2\"/>	41. 1/2\"/>
42. 1/2\"/>	42. 1/2\"/>	42. 1/2\"/>
43. 1/2\"/>	43. 1/2\"/>	43. 1/2\"/>
44. 1/2\"/>	44. 1/2\"/>	44. 1/2\"/>
45. 1/2\"/>	45. 1/2\"/>	45. 1/2\"/>
46. 1/2\"/>	46. 1/2\"/>	46. 1/2\"/>
47. 1/2\"/>	47. 1/2\"/>	47. 1/2\"/>
48. 1/2\"/>	48. 1/2\"/>	48. 1/2\"/>
49. 1/2\"/>	49. 1/2\"/>	49. 1/2\"/>
50. 1/2\"/>	50. 1/2\"/>	50. 1/2\"/>
51. 1/2\"/>	51. 1/2\"/>	51. 1/2\"/>
52. 1/2\"/>	52. 1/2\"/>	52. 1/2\"/>
53. 1/2\"/>	53. 1/2\"/>	53. 1/2\"/>
54. 1/2\"/>	54. 1/2\"/>	54. 1/2\"/>
55. 1/2\"/>	55. 1/2\"/>	55. 1/2\"/>
56. 1/2\"/>	56. 1/2\"/>	56. 1/2\"/>
57. 1/2\"/>	57. 1/2\"/>	57. 1/2\"/>
58. 1/2\"/>	58. 1/2\"/>	58. 1/2\"/>
59. 1/2\"/>	59. 1/2\"/>	59. 1/2\"/>
60. 1/2\"/>	60. 1/2\"/>	60. 1/2\"/>
61. 1/2\"/>	61. 1/2\"/>	61. 1/2\"/>
62. 1/2\"/>	62. 1/2\"/>	62. 1/2\"/>
63. 1/2\"/>	63. 1/2\"/>	63. 1/2\"/>
64. 1/2\"/>	64. 1/2\"/>	64. 1/2\"/>
65. 1/2\"/>	65. 1/2\"/>	65. 1/2\"/>
66. 1/2\"/>	66. 1/2\"/>	66. 1/2\"/>
67. 1/2\"/>	67. 1/2\"/>	67. 1/2\"/>
68. 1/2\"/>	68. 1/2\"/>	68. 1/2\"/>
69. 1/2\"/>	69. 1/2\"/>	69. 1/2\"/>
70. 1/2\"/>	70. 1/2\"/>	70. 1/2\"/>
71. 1/2\"/>	71. 1/2\"/>	71. 1/2\"/>
72. 1/2\"/>	72. 1/2\"/>	72. 1/2\"/>
73. 1/2\"/>	73. 1/2\"/>	73. 1/2\"/>
74. 1/2\"/>	74. 1/2\"/>	74. 1/2\"/>
75. 1/2\"/>	75. 1/2\"/>	75. 1/2\"/>
76. 1/2\"/>	76. 1/2\"/>	76. 1/2\"/>
77. 1/2\"/>	77. 1/2\"/>	77. 1/2\"/>
78. 1/2\"/>	78. 1/2\"/>	78. 1/2\"/>
79. 1/2\"/>	79. 1/2\"/>	79. 1/2\"/>
80. 1/2\"/>	80. 1/2\"/>	80. 1/2\"/>
81. 1/2\"/>	81. 1/2\"/>	81. 1/2\"/>
82. 1/2\"/>	82. 1/2\"/>	82. 1/2\"/>
83. 1/2\"/>	83. 1/2\"/>	83. 1/2\"/>
84. 1/2\"/>	84. 1/2\"/>	84. 1/2\"/>
85. 1/2\"/>	85. 1/2\"/>	85. 1/2\"/>
86. 1/2\"/>	86. 1/2\"/>	86. 1/2\"/>
87. 1/2\"/>	87. 1/2\"/>	87. 1/2\"/>
88. 1/2\"/>	88. 1/2\"/>	88. 1/2\"/>
89. 1/2\"/>	89. 1/2\"/>	89. 1/2\"/>
90. 1/2\"/>	90. 1/2\"/>	90. 1/2\"/>
91. 1/2\"/>	91. 1/2\"/>	91. 1/2\"/>
92. 1/2\"/>	92. 1/2\"/>	92. 1/2\"/>
93. 1/2\"/>	93. 1/2\"/>	93. 1/2\"/>
94. 1/2\"/>	94. 1/2\"/>	94. 1/2\"/>
95. 1/2\"/>	95. 1/2\"/>	95. 1/2\"/>
96. 1/2\"/>	96. 1/2\"/>	96. 1/2\"/>
97. 1/2\"/>	97. 1/2\"/>	97. 1/2\"/>
98. 1/2\"/>	98. 1/2\"/>	98. 1/2\"/>
99. 1/2\"/>	99. 1/2\"/>	99. 1/2\"/>
100. 1/2\"/>	100. 1/2\"/>	100. 1/2\"/>

Meyer & Allen Associates
 ARCHITECTS

1000 N. GARDEN STREET, SUITE 200
 COSTA MESA, CA 92626
 TEL: 714.440.1100
 FAX: 714.440.1101
 WWW.MYERANDALLEN.COM

DATE: 01/13/15
 DRAWN BY: J. BROWN
 CHECKED BY: J. BROWN
 APPROVED BY: J. BROWN

Costa Mesa Police Facility
 Expansion & Renovation
 City of Costa Mesa
 111 Fall Drive
 Costa Mesa, CA 92626

DATE: 01/13/15
 DRAWN BY: J. BROWN
 CHECKED BY: J. BROWN
 APPROVED BY: J. BROWN

BASEMENT FLOOR PLAN

SHEET
A2.1
 OF SHEETS

**EXHIBIT B:
A&E SERVICES FOR ADA RETROFITS**

EXHIBIT B: A&E SERVICES FOR ADA RETROFITS



Seung Yang, P.E.
City Engineer
City of Costa Mesa
77 Fair Dr. Costa Mesa CA 92626

Subject: **City of Costa Mesa Police Firing Range: A&E Services for ADA Improvements**

Dear Seung,

The following proposal is for providing A&E services to the selected retrofits from the ADA report that has been completed in response to the proposed renovations for the new Firing Range located at the City's Police Headquarters at 99 Fair Drive.

We understand that this project would involve an architectural, structural, and mechanical engineering scope of design improvements, planning review/ entitlement, design development, and construction support for these additional accessibility retrofits.

This proposal includes the following:

- Detailed Cost Proposal for A&E Services
- Statement of Probable Construction Costs based on respective itemized ADA Retrofits (For reference)

B. COMPENSATION

We propose to furnish these services not to exceed:

\$35,480 (Thirty-Five Thousand Four Hundred and Eighty Dollars)

Additional services outside the Scope of Work agreed upon shall not be performed without the authorization of the City. We have tailored our scope and subsequent fee proposal to accommodate the scope of work, realizing that there is latitude in both parameters to be discussed during the contract negotiation.

Sincerely,

Jack Panichapan, AIA, LEED AP, President, CEO
Gillis + Panichapan Architects, Inc.

EXHIBIT B: A&E SERVICES FOR ADA RETROFITS

FEE EXHIBIT



City of Costa Mesa
Police Firing Range Facility Upgrade Project - ADA Upgrade (Additional Services)
 5/24/2021

ARCHITECT					ARCHITECT
Principal	Project Dir.	Project Arch	Job Captain	Designer	

A Task A: Phase 1: Design Development Phase							
c	Survey site and verify record drawings with existing site conditions. Document existing site conditions. Identify opportunities and constraints for proposed improvements.			2	2	2	\$620
d	Develop As-built File of the field verified record drawings of the Firing Range.		1	2	4	4	\$1,125
e	Prepare Conceptual Design, product specifications, and preliminary ROM cost estimates including the design and cost.	2	1	8	8	8	\$3,005
f	Meet with City staff and others to obtain input and revise the Conceptual Design and cost estimates as necessary to receive City's approval.	2	1	2	2	8	\$1,625
g	Prepare exhibits of the revised Conceptual Design and cost estimate.			1	1	2	\$390
h	Project Management: review design and documented scope and extent of design is confirmed moving forward.		4	4			\$1,160
TASK A TOTAL:		4	7	19	17	24	\$7,925

B Task B: Phase 2: Construction Documents Phase and Plan Check Support							
a	70-Percent CDs: Development of 60-percent Demo, Architectural, Mech, and Electrical, Prepare preliminary technical specifications. Provide coordination with Electrical design development. Include technical specifications defining the overall project and design criteria for Firing Range Space	3	2	16	24	24	\$7,225
c	100-Percent CDs: Final comments will be incorporated from the design review meeting and plan check to complete the final drawing and specifications.	2	2	2	8	8	\$2,350
d	Project Management-coordinate City Requirements with engineer sub-consultants		2	3			\$715
TASK B TOTAL:		5	6	21	32	32	\$10,290

C Task C: Phase 3: Construction Support Services							
a	Bid Phase Services: Attend the pre-bid meeting. Provide technical support at the pre-bid meeting. Prepare addenda in response to requests for information (RFIs) and requests for clarification (RFCs). prepare a conformed set of contract documents that incorporate all addenda and revisions to the contract documents.	1	2	4	4	4	\$1,735
b	Engineering Services During Construction: review and guide the progress and direction of construction documents including RFI response, GPa will review Shop Drawings, Product Data, Samples and similar submittals to verify conformity with the information by the original contract documents Includes CALGreen Commissioning.	4	8	12	20	12	\$6,460
c	Site Visits During Construction: provide meeting on-site (Up to 4 meetings w architect)	8		8			\$2,560
d	Project Close-Out: Participate in final walk through of the site. Assist in the development of Project punch list.	1	1	8	8		\$2,180
e	Project Management-Coordination and administration		2	2			\$580
Task C Total		14	13	34	32	16	\$11,780

Hours:	23	26	74	81	72	\$29,995
Total Hours	276					SUB-TOTAL
Hourly Rates:	\$185	\$155	\$135	\$95	\$80	

\$29,995 Architecture

Structural Engineer Allowance	\$1,200
MEP Engineer Allowance	\$4,000
Reimbursibles*	\$285

Architecture and Engineering Total (Task A-D) \$35,480

*Reimbursibles: Covers costs for specialty printing, delivery fees, and travel. City Business License fees (if required for the entire A&E Team) This reimbursible allowance covers fees beyond general B&W printing fees on standard ledger or tabloid size paper. Government fees, delivery costs (such as United Parcel Service charges), and the costs of special sized prints/ reproductions are not included in our fee. These items are "reimbursible" items and will be shown separately on our invoice with a 10% coordination fee.

NOTE on Plan Check Fees: Reimbursibles and fees shown here do not include Building Department or Plan check Submittal Fees, or any other 3rd party fees not indicated in this scope. Scope of Entitlement does not include design of potential accessible upgrades that may be required for the overall building and site outside the immediate project.

EXHIBIT B: A&E SERVICES FOR ADA RETROFITS

City of Costa Mesa
 Costa Mesa P.D. - Shooting Range Upgrade (ADA)
 Statement of Probable Cost
 Date: 05/24/2021

OPTION 1 - Summary

DRAFT

Element	Quantity	Unit	Unit Cost	Total
01 General Conditions (Incl. below)				
02 Parking/Site (exterior):				\$3,500.00
03 Building (Interior):				\$8,300.00
04 Elevator:				\$60,500.00
05 Stairs:				\$11,400.00
06 Women's Lockers/Tollet				\$58,050.00
07 Men's Lockers/Tollet				\$65,925.00
Subtotal				\$207,675
<hr/>				
Subtotal				\$207,675
General Conditions		10.0%		\$20,768
Subtotal				\$228,443
Overhead & Profit		10.0%		\$22,844
Subtotal				\$251,287
Bonds & Insurance		2.5%		\$6,282.17
Subtotal				\$257,569
Design Contingency		10%		\$25,757
Subtotal				\$283,326
Construction Contingency		10%		\$28,333
TOTAL ESTIMATE				\$311,658

EXHIBIT B: A&E SERVICES FOR ADA RETROFITS

City of Costa Mesa
 Costa Mesa P.D. - Shooting Range Upgrade (ADA)
 Statement of Probable Cost
 Date: 05/24/2021

Detail
 DRAFT

Element	Quantity	Unit	Unit Cost	Total
01 General Conditions (Incl. below)				
02 Parking/Site (exterior):				
New/Replaced Parking signage (Driveway entrance)	1	LS	\$300.00	\$300.00
New accessible stall paint marking	1	LS	\$1,000.00	\$1,000.00
Grind A.C. and Concrete to be flush at path of travel (1/4" +/-)	1	LS	\$800.00	\$800.00
New accessible stall paint marking (International symbol)	1	LS	\$600.00	\$600.00
New/Replaced Parking signage (Stall identification)	1	LS	\$800.00	\$800.00
Sub-total				\$3,500.00
03 Building (Interior):				
Replace protruding object in path of travel (4" max.)	1	LS	\$600.00	\$600.00
B01 Entrance: Provide Lever type door hardware	1	ea	\$800.00	\$800.00
B01 Entrance: Remove existing kick-down door stop. Provide overhead door stop (if allowed by Wall/Door rating)	1	LS	\$900.00	\$900.00
B01: Entrance: Adjust or replace door closer	1	ea	\$800.00	\$800.00
B01: relocate cabinet to provide 60" clear.	1	LS	\$500.00	\$500.00
B01: relocate Room Signage	1	LS	\$800.00	\$800.00
B03: Door: Remove kick-down door stop. Provide overhead door stop (if allowed by Wall/Door rating)	1	LS	\$900.00	\$900.00
B03: relocate Room Signage	1	LS	\$800.00	\$800.00
Signage: Provide tactile Braille "EXIT" signage.	1	ea	\$250.00	\$250.00
Signage: Stairs: Provide tactile Braille signage "EXIT STAIR DOWN,UP".	1	ea	\$250.00	\$250.00
Signage: Provide tactile Braille "EXIT ROUTE" signage (Stair 1 and at room B01)	2	ea	\$250.00	\$500.00
Drinking Fountain: Basement: relocate adjacent railings	1	LS	\$1,200.00	\$1,200.00
Sub-total				\$8,300.00
04 Elevator:				
Call Buttons: replace or provide additional buttons at wall (lighted/ registered)	2	ea	\$1,500.00	\$3,000.00
Call Signal: provide lighted signal (wall mounted -high)	2	ea	\$1,500.00	\$3,000.00
Signage: Braille floor level signs (each floor)	2	ea	\$250.00	\$500.00
Elevator doors: install auto-operators for doors.	2	ea	\$20,000.00	\$40,000.00
Elevator Car: Options for elevator finishes/materials for options to widen cab.	1	LS	\$4,000.00	\$4,000.00
Elevator Car control buttons: Replace as required to comply	1	LS	\$8,000.00	\$8,000.00
Elevator Limited Type certification	1	LS	\$2,000.00	\$2,000.00
Sub-total				\$60,500.00
05 Stairs:				
Provide signage (Braille floor level) at each floor level landing/door	2	ea	\$250.00	\$500.00

EXHIBIT B: A&E SERVICES FOR ADA RETROFITS

City of Costa Mesa
 Costa Mesa P.D. - Shooting Range Upgrade (ADA)
 Statement of Probable Cost
 Date: 05/24/2021

Detail DRAFT

Element	Quantity	Unit	Unit Cost	Total
Provide/replace outside handrail at middle landings.	60	LF	\$165.00	\$9,900.00
Provide guard rail at underside of Stairs	1	ea	\$1,000.00	\$1,000.00
Sub-total				<u>\$11,400.00</u>

06 Women's Lockers/Toilet

Signage: Replace braille signage at wall. Relocate sign at door	1	ea	\$250.00	\$250.00
B19: Remove kick-down hold open	1	ea	\$300.00	\$300.00
B19: Adjust or replace door closer	1	ea	\$900.00	\$900.00
B19: Door clearance: provide and install low energy door operat	1	ea	\$16,000.00	\$16,000.00
B19: Remove or relocate protrusion at wall or provide detectable barrier below item	1	ea	\$900.00	\$900.00
Signage: relocate room signage	1	ea	\$800.00	\$800.00
B20: Install ADA Circle symbol on door	1	ea	\$250.00	\$250.00
B20: Remove kick-down hold open	1	ea	\$300.00	\$300.00
B20: Adjust or replace door closer	1	ea	\$900.00	\$900.00
Accessible toilet partition: replace partition door hardware with self-closing device	1	LS	\$3,000.00	\$3,000.00
Accessible toilet stall clearance: replace adjacent sink to provide 60" clear	1	LS	\$8,000.00	\$8,000.00
Accessible toilet stall clearance: reconfigure stall door providing 4" max. jamb	1	ea	\$1,000.00	\$1,000.00
Accessible toilet stall door: install additional door pull 34" to 44" high	1	ea	\$1,000.00	\$1,000.00
Accessble toilet stall: relocate/adjust grab bars	1	LS	\$1,500.00	\$1,500.00
Accessible toilet stall: install/relocate toilet tissue dispenser rolls	1	LS	\$1,500.00	\$1,500.00
Accessible toilet stall: install/relocate toilet seat cover dispenser rolls	1	LS	\$1,500.00	\$1,500.00
Accessible toilet stall: install/relocate disposal unit	1	LS	\$1,500.00	\$1,500.00
B21: Door signage: Install ADA Circle symbol on door	1	ea	\$250.00	\$250.00
B21: Shower stall: replace diverter controls and relocated Water valve controls and Hand held spray unit	1	LS	\$6,000.00	\$6,000.00
B21: Shower stall: cut back plastic partition	1	LS	\$800.00	\$800.00
B21: Shower stall: replace floor tile and provide max. slope of 2.08%	1	LS	\$8,000.00	\$8,000.00
B21: Threshold: replace door threshold	1	ea	\$500.00	\$500.00
B21: Floor Drain. Retile floor and reset floor drain	1	LS	\$2,000.00	\$2,000.00
B21: Sink drains: provide Insulated pipes	1	ea	\$250.00	\$250.00
Sink, Label Accessible sink in one room	1	ea	\$250.00	\$250.00
B21: Sink, Replace soap dispenser	1	ea	\$400.00	\$400.00
Sub-total				<u>\$58,050.00</u>

EXHIBIT B: A&E SERVICES FOR ADA RETROFITS

City of Costa Mesa
 Costa Mesa P.D. - Shooting Range Upgrade (ADA)
 Statement of Probable Cost
 Date: 05/24/2021

Detail DRAFT

Element	Quantity	Unit	Unit Cost	Total
07 Men's Lockers/Toilet				
Signage: Replace braille signage at wall. Relocate sign at door	575 sf		\$35.00	\$20,125.00
B18: Remove kick-down hold open	575 sf		\$12.00	\$6,900.00
B18: Adjust or replace door closer	575 sf		\$20.00	\$11,500.00
B18: Recess fire extinguisher (4" maximum protrusion)	1 ea		\$1,200.00	\$1,200.00
Signage: Relocate braille signage	1 ea		\$800.00	\$800.00
B16: Replace door signage	1 ea		\$250.00	\$250.00
Door to B16: Remove kick-down hold open	1 ea		\$300.00	\$300.00
Door to B16: Adjust or replace door closer	1 ea		\$900.00	\$900.00
Urinal: Relocate/replace paper towel combo	1 ea		\$400.00	\$400.00
Accessible toilet partition: replace partition door hardware with self-closing device	1 ea		\$3,000.00	\$3,000.00
Accessible toilet stall clearance: replace adjacent sink to provide 60" clear	1 ea		\$8,000.00	\$8,000.00
Accessible toilet stall: reconfigure partitions	ea		\$1,000.00	\$0.00
Accessible toilet stall: relocated/replace grab bars	1 ea		\$1,500.00	\$1,500.00
B17: Replace/relocate door signage	1 ea		\$800.00	\$800.00
Accessible shower: Relocate/replace/adjust seat	1 ea		\$2,000.00	\$2,000.00
Accessible shower: Relocate/replace/adjust water valve	1 ea		\$2,000.00	\$2,000.00
Accessible shower: Relocate/replace hand held spray unit	1 ea		\$4,000.00	\$4,000.00
Accessible shower: Floor Drain. Retile floor and reset floor drain	1 ea		\$2,000.00	\$2,000.00
B16: Sinks: Insulate sink drains (completely)	1 ea		\$250.00	\$250.00
Sub-total				<u>\$65,925.00</u>

**EXHIBIT C:
SUPPLEMENTAL CONSTRUCTION
ADMINISTRATION**



October 19, 2021

Seung Yang, P.E.
City Engineer
City of Costa Mesa
77 Fair Dr. Costa Mesa CA 92626

Re: City of Costa Mesa Police Firing Range: Supplemental Construction Support Services

Seung,

This proposal would provide enhanced construction support services for renovation of City of Costa Mesa Police Firing Range including the additional scope for the ADA and accessibility retrofits to the existing facility.

A. PROJECT UNDERSTANDING

Supplemental Construction Administration and Support

The following additional architectural services to be provided during Construction:

- Attend weekly meetings during construction and assist City with formatting Weekly meeting minutes.
- Review and provide Input on Contractor's construction schedule and status.
- Review and provide Input on Contractor's order project updates for the project.
- Assist in coordination of Fire Safety Enhancements and Retrofits
- Assist City in reviewing coordination between the Contractor and City 's vendors (including telecommunications, audio visual, low voltage cabling, security, and furniture).
- Assist City in Construction Change Directives during construction.
- Assist City in reviewing of Contractor invoicing and credits with the city.
- Conduct field reviews to observe work by Contractor. Development of Field Reports as needed identifying observed work that is not consistent with the Construction Documents. (3 field reviews provided)
- Provide one follow-up visit after Punchlist to confirm that the noted construction deficiencies have been corrected or provide a summary of the deficiencies.

The scope of these services is based on the 80 working day construction schedule projected for this project.

B. COMPENSATION

We propose to furnish these services not to exceed the following fee:

Grand Total: \$32,000 (Thirty-Two Thousand Dollars)

Additional services outside the Scope of Work agreed upon shall not be performed without the authorization of the City. We have tailored our scope and subsequent fee proposal to accommodate the scope of work, realizing that there is latitude in both parameters to be discussed during the contract negotiation. We look forward to working with you on this project.

Sincerely,

Jack Panichapan, AIA, LEED AP
Principal, CEO,
Gillis + Panichapan Architects, Inc.